

Data Sheet

TIMax® Mesh sun protection insert

Date 26.7.2021

**TIMax® Mesh** is a white translucent PES mesh fabric.

TIMax® Mesh is a translucent sun protection insert, that can be used in combination with the glass fiber material TIMax® GL or TIMax® GL-PlusF.

TIMax® Mesh is bonded to the inner side of the outer glass pane and reduces the solar heat gain coefficient for solar radiation (g-value) of the profiled glass facade.

The U-value of the profiled glass facade is only slightly improved by TIMax® Mesh.

Installation: See installation instructions

**Tender text for download under:**

[www.wacotech.de](http://www.wacotech.de), products profiled glass

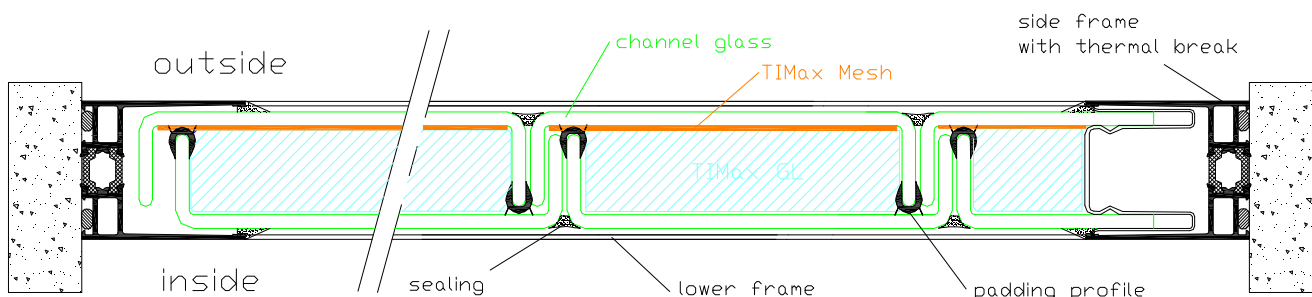

**Technical data**

for TIMax® Mesh sun protection insert in double-glazed U-profiled glass

Glass type + frame system	insulating insert	U <sub>g</sub> -value [W/m²K]	g-value direct	light transm. τ direct	noise red. R <sub>w</sub> [dB]
60mm channel glass (inner and outer glass), within a 83mm frame, with approx. 56mm air gap	<b>TIMax® Mesh</b> with TIMax® GL	1,4*	0,24*	0,24*	44* **
	<b>TIMax® Mesh</b> with TIMax® GL-PlusF	1,2*	0,23*	0,23*	44* **
60mm channel glass (inner and outer glass), within a 83mm frame, with approx. 56mm air gap	<b>TIMax® Mesh Decor</b> with TIMax® GL	1,4*	0,20*	0,19*	44* **
	<b>TIMax® Mesh Decor</b> with TIMax® GL-PlusF	1,2*	0,17*	0,16*	44* **

\* measured values, test certificate available

\*\* using TIMax® GL insulation improves the noise insulation about 1dB