

Data Sheet

TIMax® Mesh sun protection insert

Date 25.3.2019

TIMax® Mesh is a white translucent PES mesh fabric. It can be coloured in RAL and NCS shades. TIMax® Mesh is a translucent sun protection insert, that can be used in combination with the glass fiber material TIMax® GL or TIMax® GL-PlusF. TIMax® Mesh is bonded to the inner side of the outer glass pane and reduces the solar heat gain coefficient for solar radiation (g-value) of the profiled glass facade.

The color coating offers additional design options. The U-value of the profiled glass facade is only slightly improved by TIMax® Mesh.

Installation: See installation instructions

Tender text for download under:
www.wacotech.de, products profiled glass

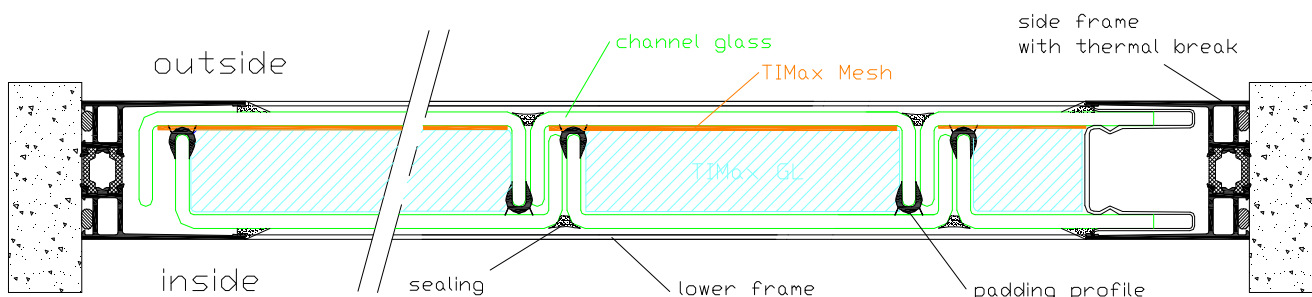

Technical data

for TIMax® Mesh sun protection insert in double-glazed U-profiled glass

Glass type + frame system	insulating insert	Ug-value [W/m²K]	g-value direct	light transm. τ direct	noise red. Rw [dB]
60mm channel glass (inner and outer glass), within a 83mm frame, with approx. 56mm air gap	TIMax® Mesh with TIMax® GL	1,4*	0,24*	0,24*	44* **
	TIMax® Mesh with TIMax® GL-PlusF	1,2*	0,23*	0,23*	44* **
60mm channel glass (inner and outer glass), within a 83mm frame, with approx. 56mm air gap	TIMax® Mesh Decor with TIMax® GL	1,4*	0,20*	0,19*	44* **
	TIMax® Mesh Decor with TIMax® GL-PlusF	1,2*	0,17*	0,16*	44* **

* measured values, test certificate available

** using TIMax® GL insulation improves the noise insulation about 1dB