

Data Sheet

TIMax<sup>®</sup> LT, Light Scattering Insert

Date 25.3.2019

**TIMax<sup>®</sup> LT** is a translucent woven glass fiber insert material which is utilized exclusively in combination with the insulation material TIMax<sup>®</sup> GL or TIMax<sup>®</sup> GL-PlusF. It improves the look of the glass facade from the inside.

In addition, the light scattering effect and the solar heat gain coefficient of the façade are enhanced by TIMax<sup>®</sup> LT.

TIMax<sup>®</sup> LT has a very fine, fleece-like structure, which creates an appealing uniform look on the inside of the glass facade. The insert covers the coarser structure of the glass-fiber insulation and is

often used for visually demanding applications such as art galleries, theaters and public buildings. The U-value of the profiled glass facade is only slightly improved by TIMax<sup>®</sup> LT.

Installation: See installation instructions

**Tender text for download under:**

[www.wacotech.de](http://www.wacotech.de), products profiled glass

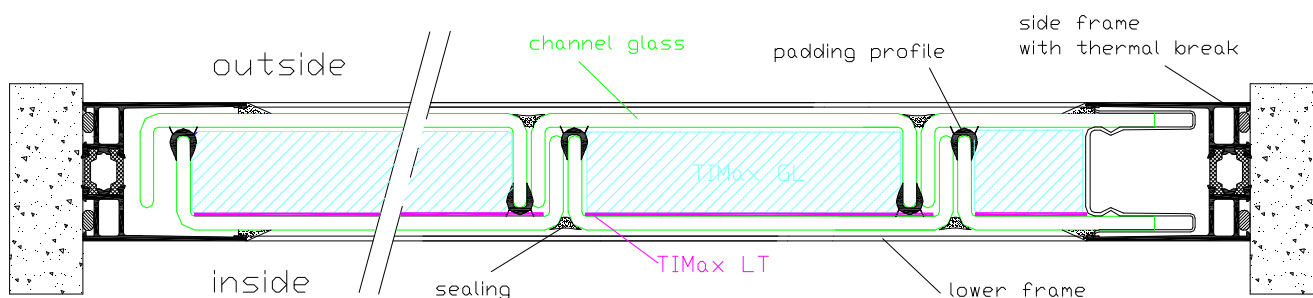

**Technical data**

for TIMax<sup>®</sup> LT light scattering insert in double-glazed U-profiled glass

Glass type + frame system	insulating insert	U <sub>g</sub> -value [W/m <sup>2</sup> K]	g-value direct	light transm. τ direct	noise red. R <sub>w</sub> [dB]
60mm channel glass (inner and outer glass), within a 83mm frame, with approx. 56mm air gap	TIMax <sup>®</sup> LT with TIMax <sup>®</sup> GL	1,4*	0,26*	0,28*	44* **
	TIMax <sup>®</sup> LT with TIMax <sup>®</sup> GL-PlusF	1,2*	0,22*	0,22*	44* **

\* measured values, test certificate available

\*\* using TIMax GL insulation improves the noise insulation about 1dB