

Data Sheet

System Ug 0,8

Date 24.3.2019

Considerably-improved U-values can be attained in profiled glass with the **System Ug 0.8** by enlarging the space between the panes to 152mm. This is achieved by using two single-layered profiled glass systems set against each other and offset relative to each other (see drawing below).
 Two layers of TIMax® GL are then used in the Ug 0.8 system, and an Ug-value of 0,79W/m²K is achieved. An even better thermal insulation is achieved with two layers of our denser material TIMax® GL-PlusF (Ug-value 0,66W/m²K). The system also offers optimum light scattering and light distribution into the depths of the room. The valid height of the glass façade depends on the statically dimensioning for single-layered profiled glass systems. In comparison

to double-layered profiled glass systems, the valid height is less. A three layer system with the double glazing on the inside can be used for sport facilities, to pass the German ball impact safety regulation. A triple glazed design with the double glazing on the outside improves the systems stability and may be required when planning with higher wind loads or longer glass panes.

Installation: See installation instructions

Tender text for download under:
www.wacotech.de, products profiled glass

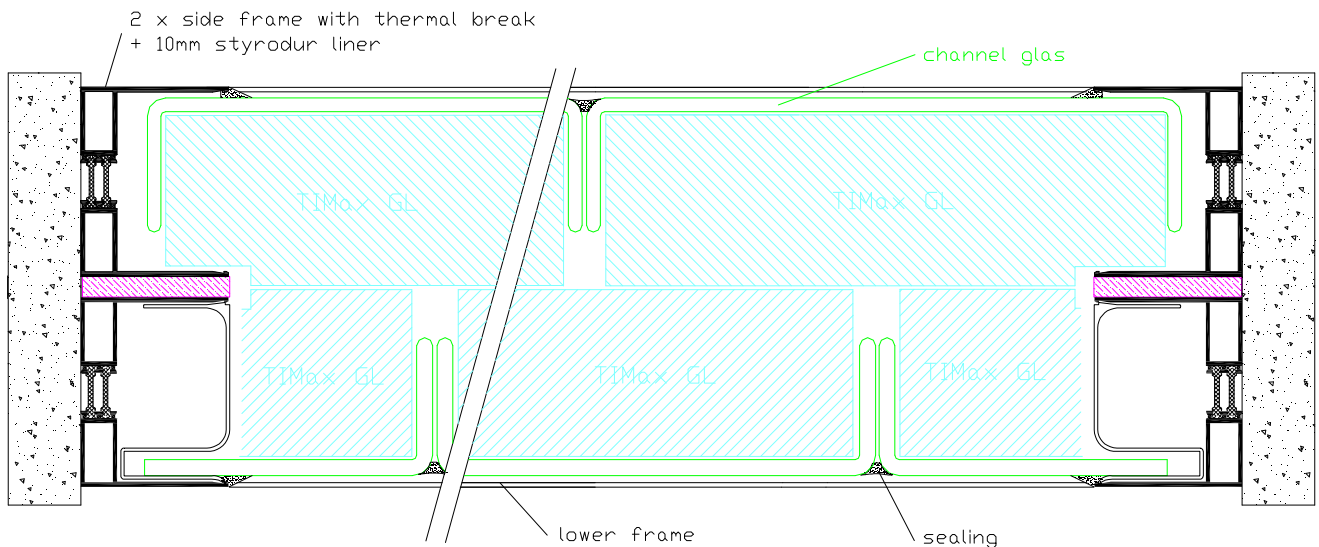

Technical data

for System Ug 0,8 with two layers of TIMax® GL or TIMax® GL-PlusF in profiled glass with extended interpane space of 152mm

Glass type + frame system	insulating insert	Ug-value [W/m²K]	g-value direct	light transm. τ direct	noise red. Rw [dB]
Inside- and outside-shell profiled glass type 262/60/7 with air gap of approx. 152mm, two separate frames with 10mm Styrodur liner.	two layers TIMax® GL	0,79*	0,23*	0,25*	53*
	two layers TIMax® GL-PlusF	0,66*	0,16*	0,17*	53*

* measured values, test certificate available